

Tip 1

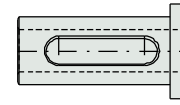
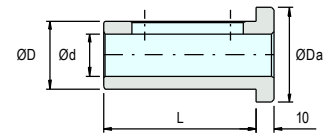

Tip 2

Kod Code Bezeichnung	DIN 69980	Ölçüler Dimensions Abmessungen				
		ØD	Ød	ØDa	L	Tip
ADPT 39 76 202	E2 - 1 - 25 x 8	25	8	30	60	1
39 76 204	E2 - 1 - 25 x 10	25	10	30	60	1
39 76 206	E2 - 1 - 25 x 12	25	12	30	60	1
39 76 208	E2 - 1 - 32 x 8	32	8	40	70	1
39 76 210	E2 - 1 - 32 x 10	32	10	40	70	1
39 76 212	E2 - 1 - 32 x 12	32	12	40	70	1
39 76 214	E2 - 1 - 32 x 16	32	16	40	70	1
39 76 216	E2 - 1 - 32 x 20	32	20	40	70	2
39 76 218	E2 - 1 - 40 x 8	40	8	45	80	1
39 76 220	E2 - 1 - 40 x 10	40	10	45	80	1
39 76 222	E2 - 1 - 40 x 12	40	12	45	80	1
39 76 224	E2 - 1 - 40 x 16	40	16	45	80	1
39 76 226	E2 - 1 - 40 x 20	40	20	45	80	2
39 76 228	E2 - 1 - 40 x 25	40	25	45	80	2
39 76 230	E2 - 1 - 50 x 16	50	16	55	90	1
39 76 232	E2 - 1 - 50 x 20	50	20	55	90	2
39 76 234	E2 - 1 - 50 x 25	50	25	55	90	2
39 76 236	E2 - 1 - 50 x 32	50	32	55	90	2

**Mors Konik Adaptör**  
Adaptor Morse Taper  
Adapter Morsekegel

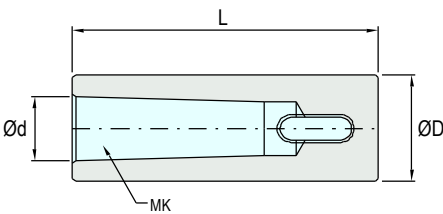

Kod Code Bezeichnung	DIN 69980	Ölçüler Dimensions Abmessungen			
		ØDa	MK	Ød	L
ADPT 39 76 302	E2 - 3 - 32 x 2	32	2	17.780	90
39 76 304	E2 - 3 - 32 x 3	32	3	23.825	110
39 76 306	E2 - 3 - 40 x 2	40	2	17.780	90
39 76 308	E2 - 3 - 40 x 3	40	3	23.825	110
39 76 310	E2 - 3 - 50 x 2	50	2	17.780	90
39 76 312	E2 - 3 - 50 x 3	50	3	23.825	110
39 76 316	E2 - 3 - 50 x 4	50	4	31.267	135

**Mandren Tutucu**  
Drill Chuck Holder  
Bohrenwerkzeughalter

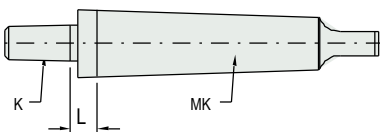

Kod Code Bezeichnung	DIN 69980	Ölçüler Dimensions Abmessungen		
		MK	K	L
ADPT 51 40 254	MK1 x B10	1	B10	11.5
51 40 255	MK2 x B10	2	B10	13
51 40 258	MK1 x B12	1	B12	10.5
51 40 259	MK2 x B12	2	B12	12.5
51 40 262	MK1 x B16	1	B16	14
51 40 263	MK2 x B16	2	B16	15
51 40 264	MK3 x B16	3	B16	16
51 40 267	MK1 x B18	1	B18	12.5
51 40 268	MK2 x B18	2	B18	13
51 40 269	MK3 x B18	3	B18	15.5
51 40 270	MK4 x B18	4	B18	18.5